

FUN WORLD-EP₄₀₀



HIGH PERFORMANCE

KM0203800

Outrunner Motor Included!

Max Speed 26500 rpm
Operating Power 180 W
Operating Voltage 6-12 V
Operating Current 15 A
Peak Current 20 A (max 15 s)
Shaft diameter 2.3 mm
Diameter 28 mm
Length 26mm
Weight 50 g



Outrunner Motor

**Requires : 4 - channel radio w/ 4 micro servos,
20A Brushless ESC, 3 cells 11.1V
2100 mAh Li-Po battery & charger.**

Specifications

Wing Span	39.5 in / 1000mm
Wing Area	421 sq in / 27.2 sq dm
Flying Weight	25.4 oz / 720g
Fuselage Length	39.5 in / 1000mm

Specifications are subject to change without notice.

Warning ! This model is not a toy.

It is designed for maximum performance. Please seek advice if one is not familiar with this kind of electric powered precision model. Operating this model without prior preparation may cause injuries. Remember, safety is the most important thing. Always keep this instruction manual at hand for quick reference.



**THE WORLD MODELS
MANUFACTURING CO.,LTD.**
FACTORY PRE-FABRICATED
ALMOST-READY-TO-FLY (ARF) SERIES
MADE IN CHINA
www.theworldmodels.com

FUN WORLD-EP₄₀₀

INDEX

BEFORE YOU BEGIN	P. 1
PARTS LIST	P. 2
ASSEMBLY	P. 3 - 10
SAFETY PRECAUTIONS	P. 10

BEFORE YOU BEGIN

- 1** Read through the manual before you begin, so you will have an overall idea of what to do.
- 2** Check all parts. If you find any defective or missing parts contact your local dealer. Please DRY FIT and check for defects for all parts that will require CA or Epoxy for final assembly. Any parts you find to be defective after the gluing process may be difficult to remove for warranty replacement. The manufacturer will replace any defective parts, but will not extend to the parts that are good before gluing to defective parts during assembly. Warranty will not cover any parts modified by customer.
- 3** Symbols used throughout this instruction manual comprise of the following : -



Apply epoxy glue.



Apply instant glue
(C.A.glue, super glue.)



Assemble left and right
sides the same way.



Ensure smooth non-binding
movement while assembling.



Peel off shaded portion
covering film.



Cut off shaded portion.



Drill holes with the specified
diameter (here: 3mm).



Must be purchased separately!



Pay close attention here!



Do not overlook this symbol!



Pierce the shaded portion
covering film.



Parts List

1. MAIN WING -- 1 pair
2. PUSHROD Ø1.4x105mm w/ Threads (For Aileron) -- 2 pcs
STRAPER -- 2 pcs
CLEVIS -- 2 pcs
FUEL TUBE d2xD4x4mm -- 4 pcs
HORN -- 2 sets
SCREW PM2x10mm -- 4 pcs
3. FUSELAGE -- 1 pc.
STABILIZER & ELEVATOR -- 1 set
4. VERTICAL FIN & RUDDER -- 1 set
5. TAIL LANDING GEAR -- 1 set
PLASTIC COLLAR d1XD5x2mm -- 2pcs
TAIL WHEEL Ø23mm -- 1 pc.
ALUMINUM PLATE 0.3mm -- 1pc.
SCREW PA2x8mm -- 2 pcs
SCREW PM2x8mm -- 1 pc.
M2 NUT -- 1 pc.
6. MAIN LANDING GEAR -- 1 set
MAIN WHEEL Ø40mm -- 2 sets
COLLAR 2.6mm w/ set screw -- 2 pcs
LANDING WIRE STRAPS PL4114030 -- 3 pcs
SCREW PA2.3x10mm -- 6 pcs
7. PUSHROD Ø1.4x420mm w/ Threads (For Elevator) -- 2 pcs
CLEVIS -- 2 pcs
HORN -- 2 sets
SCREW PM2x10mm -- 4 pcs
FUEL TUBE d2xD4x4mm -- 2 pcs
8. PUSHROD Ø1.4x510mm w/ Threads (For Rudder) -- 1 pc.
CLEVIS -- 1 pc.
FUEL TUBE d2xD4x4mm -- 1 pc.
HORN -- 1 set
SCREW PM2x10mm -- 2 pcs
9. KM0203800 OUTRUNNER MOTOR (Ø2.3mm) -- 1 set
400 GEARBOX -- 1 set
FOLDING PROPELLER SET(11X5) -- 1 set
SPINNER Ø36mm -- 1 set
COWLING -- 1 pc.
SCREW PWA2x8mm -- 4 pcs
10. PUSHROD Ø1.4x100mm (For Elevator) -- 1 pc.
PUSHROD CONNECTOR PL4410020 -- 1 set
FUEL TUBE d2xD4x4mm -- 2 pcs
STRAPER -- 2 pcs
SPONGE 10x50x150mm -- 1 pc.
BATTERY TIE 200mm -- 1 pc.
DOUBLE-SIDED TAPE 30x35mm -- 1 pc.
SCREW PM2x10mm -- 2 pcs
WASHER d2xD5mm -- 2 pcs
M2 NYLON INSERT LOCK NUT -- 2 pcs
MOUNTING PLATE PL4114015 -- 2 pcs
PLYWOOD 2x56x95mm -- 1 pc.
BALSA 1.5x56x205mm -- 1 pc.
11. CANOPY -- 1 pc.
SCREW PWA2x8mm -- 4 pcs
12. EYE SCREW PA2.5x10x23mm -- 2 pcs
WING TUBE Ø9.6x240mm -- 1 pc.
RUBBER BAND D30x1mm -- 2 pcs
13. DECALS -- 1 set
- COVERING:-
LIGHTEX SGX000 TRANSPARENT
LIGHTEX SGX030 TRANSPARENT YELLOW
LIGHTEX SGX100 WHITE
LIGHTEX SGX050 TRANSPARENT BLUE
LIGHTEX SGX241 TURQUOISE
LIGHTEX SGX360 VIOLET
LIGHTEX SGX330 CADMIUM YELLOW
LIGHTEX SGX313 PINK
LIGHTEX SGX201 BLACK
LIGHTEX SGX251 SKY BLUE
LIGHTEX SGX250 BLUE
LIGHTEX SGX311 FERRARI RED
LIGHTEX SGX310 RED

1 Main Wing

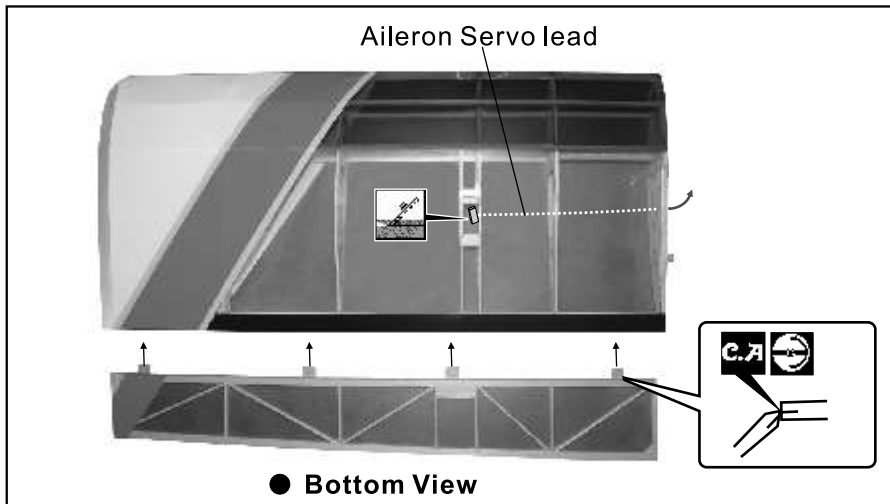

● Apply instant type CA glue to both sides of each hinge.

L/R

2 Aileron Servo

PM2x10mm Screw 4

● Ø1mm pilot holes for World Models control horn are pre-drilled. Please look for pin-hole marks at under side of control surfaces.

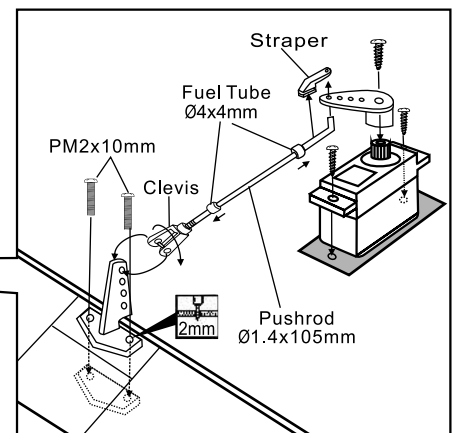
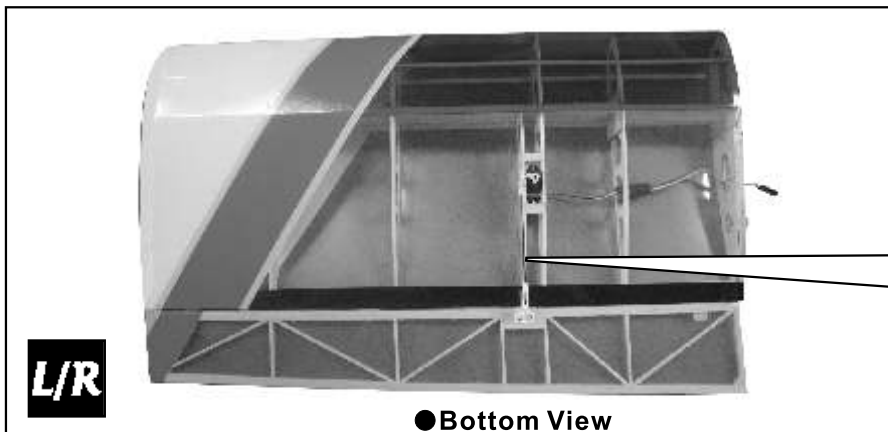

3 Stabilizer & Elevator

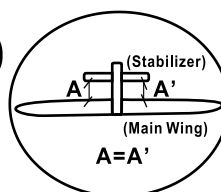

Temporary install the main wing, adjust leveling of the stabilizer to make it as parallel to the main wing as possible.

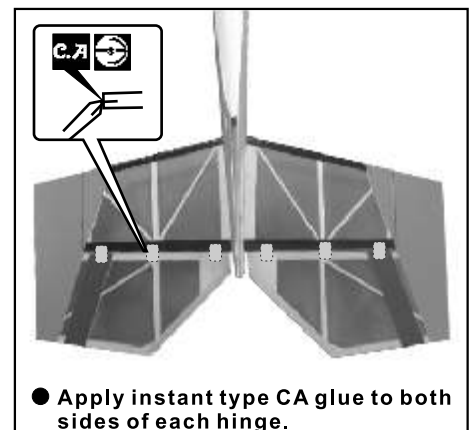
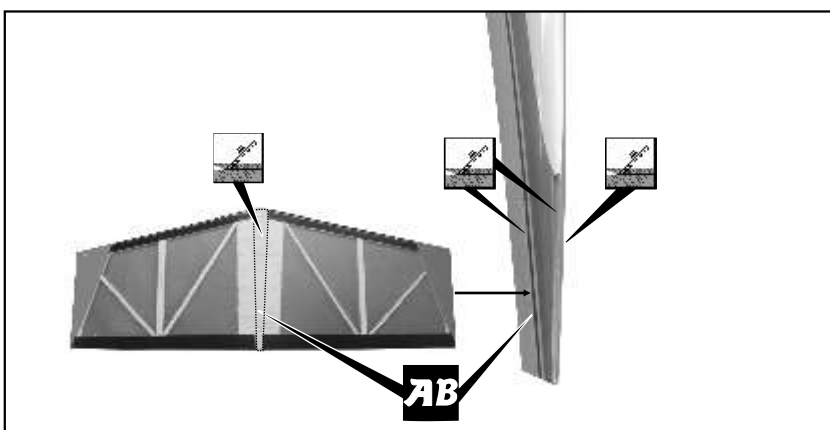
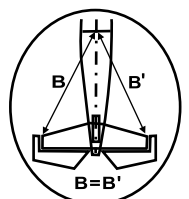

4 Vertical Fin & Rudder

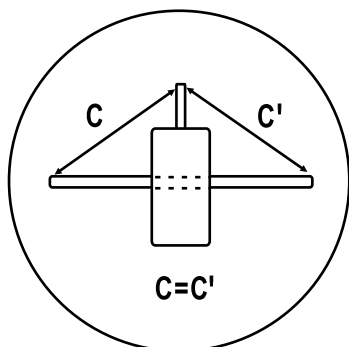
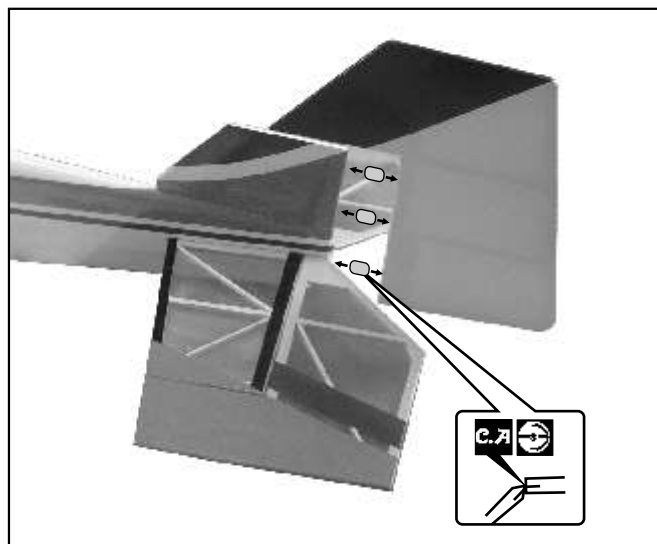
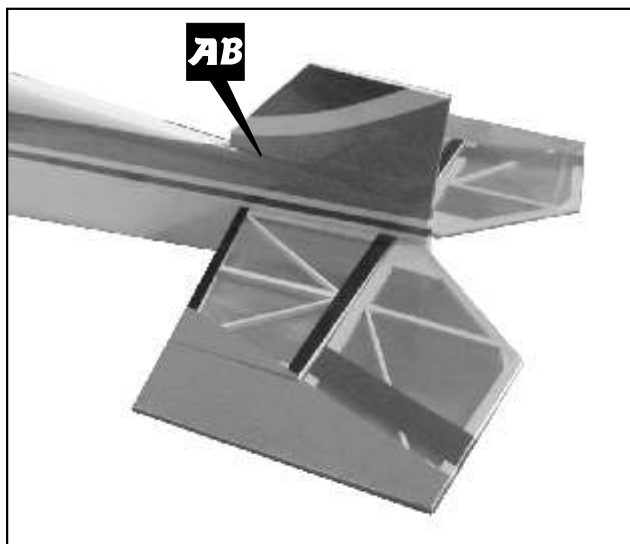

- Apply instant type CA glue to both sides of each hinge.

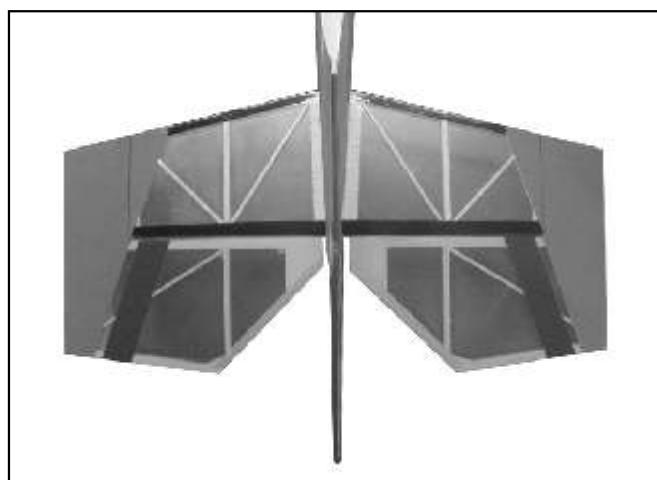

● Completed

5 Tail Landing Gear

PA2x8mm Screw	2
PM2x8mm Screw	1
M2 NUT	1

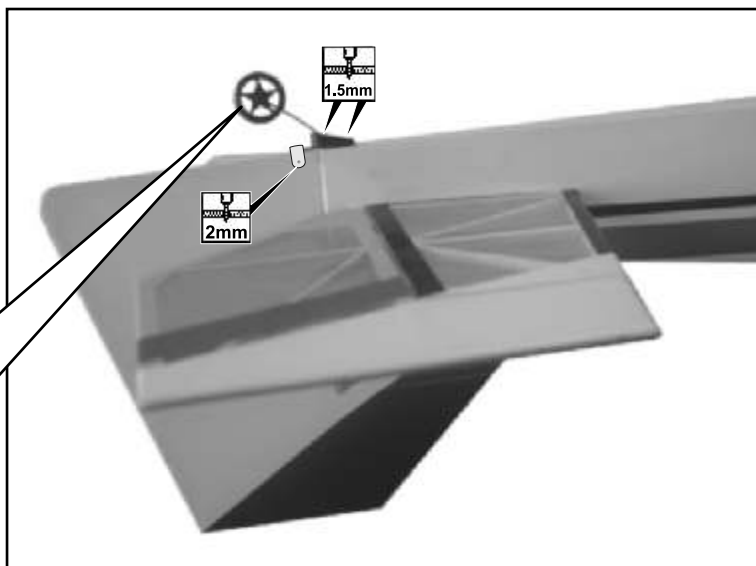
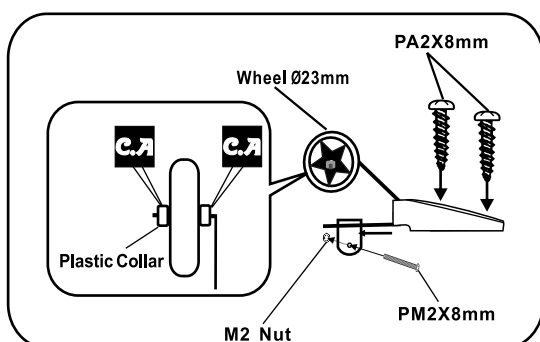

● Bottom View

6 Main Landing Gear

PA2.3x10mm Screw

6

2.6mm Collar

2

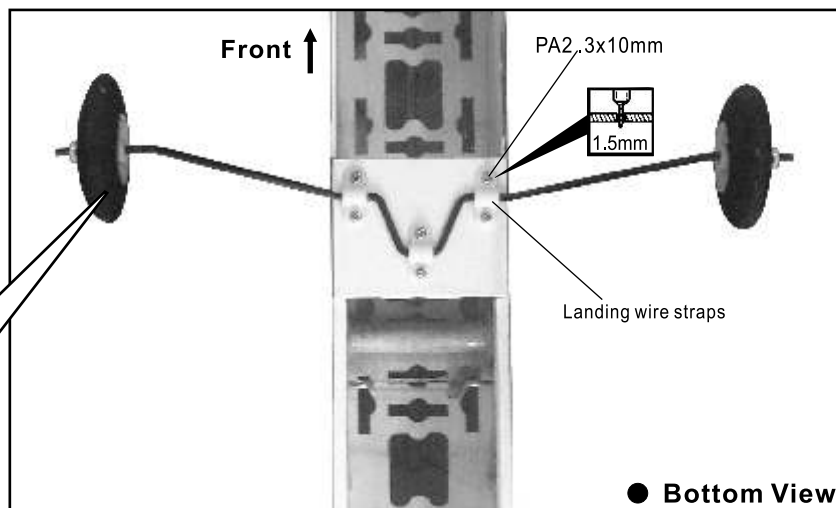
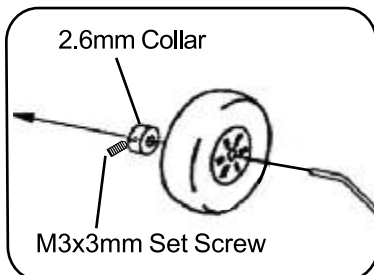

L/R

7 Elevator Pushrod

- Ø1mm pilot holes for World Models tri-horn are pre-drilled. Please look for pin-hole marks at under side of control surfaces.

PM2x10mm Screw

4

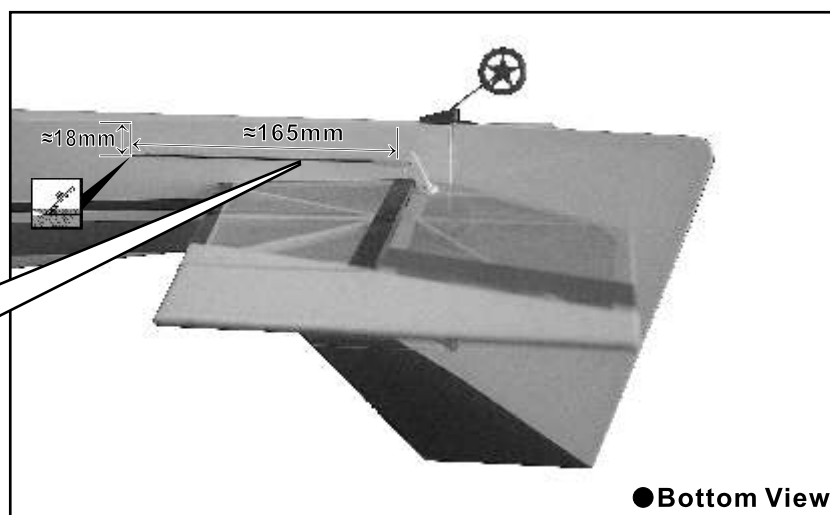
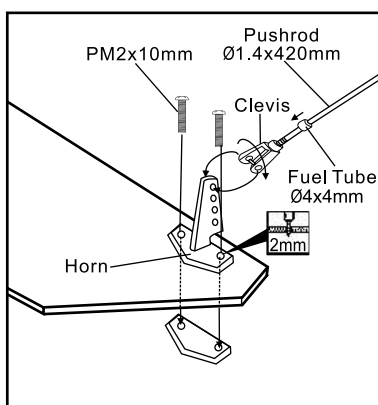

L/R

8 Rudder Pushrod

- Ø1mm pilot holes for World Models tri-horn are pre-drilled. Please look for pin-hole marks at side of control surfaces.

PM2x10mm Screw

2

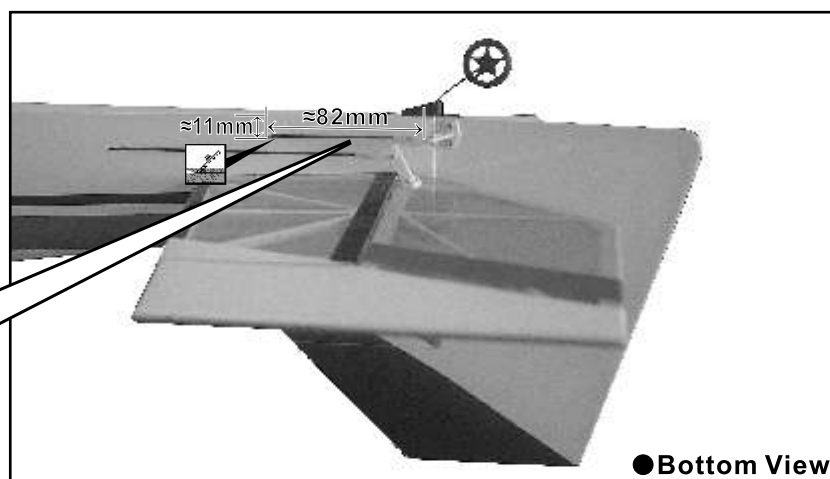
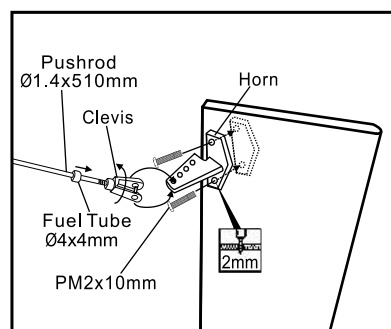

9 Outrunner Motor & Cowling

M2.6 x 7mm Socket Head Screw	2
PM2 x 12mm Screw	4
PWA2 x 8mm Screw	4
PA2.6 x 8mm Screw	2
M2 Nut	2
d2 x D5mm Washer	4
d2.6 x D8mm Washer	2
M3x3mm Set Screw	1

- TO ALLOW FOR BACKLASH OF MATCHING GEAR, PUT A PIECE OF THIN PAPER BETWEEN THE GEARS AND THEN TIGHTEN THE M2.6X7mm SCREWS. REMOVE THE PAPER BEFORE FLYING.

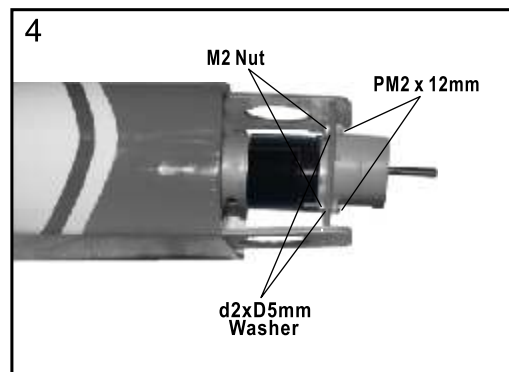
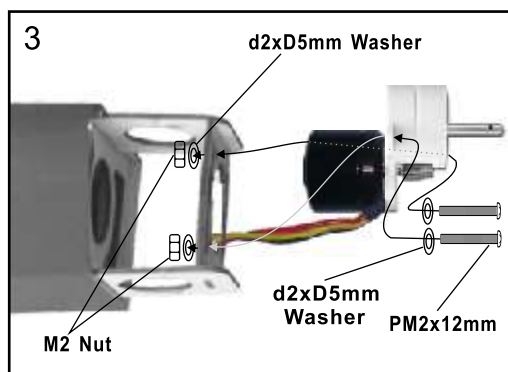
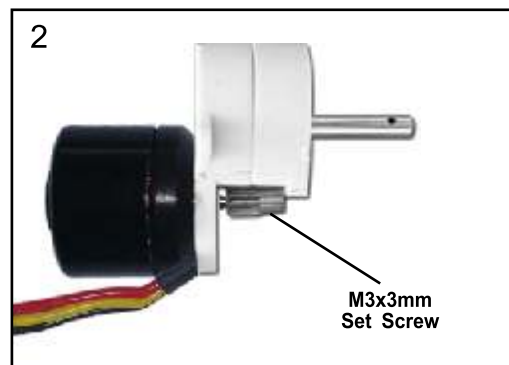
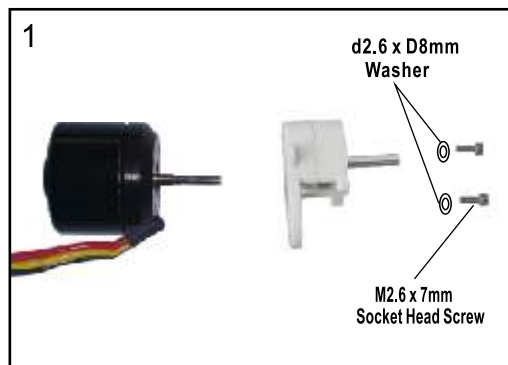
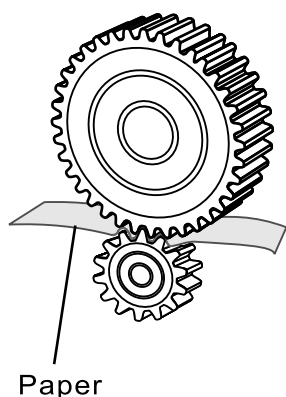

- Make sure rotating motor casing is not in contact with wirings or anything.

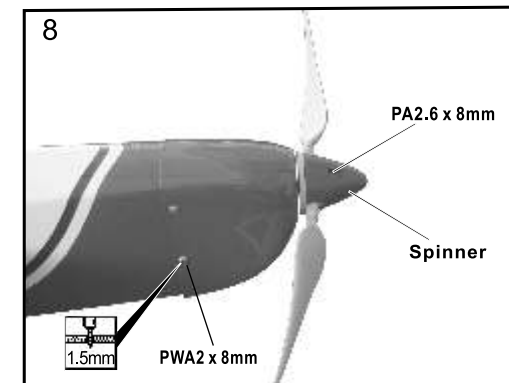
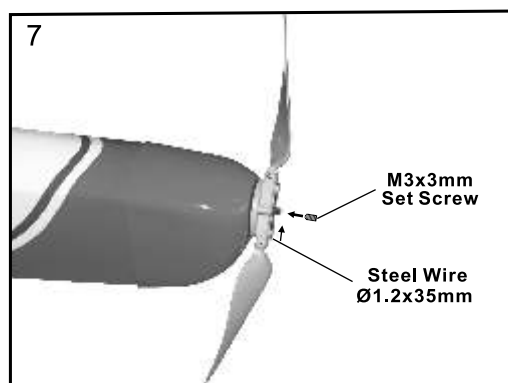
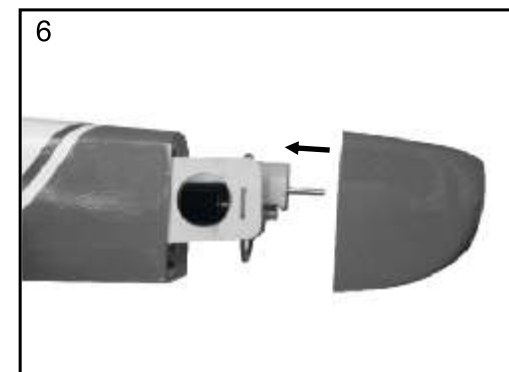
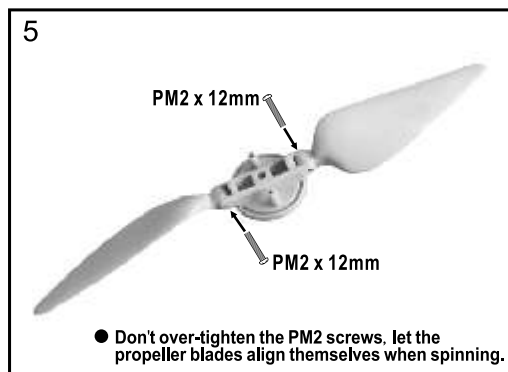

10 Radio Equipment

PM2 x10mm **Screw**

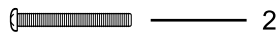

M2 Nylon Insert Lock Nut

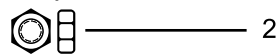

d2 x D5mm **Washer**

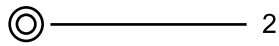

- Receiver wrapped up in sponge

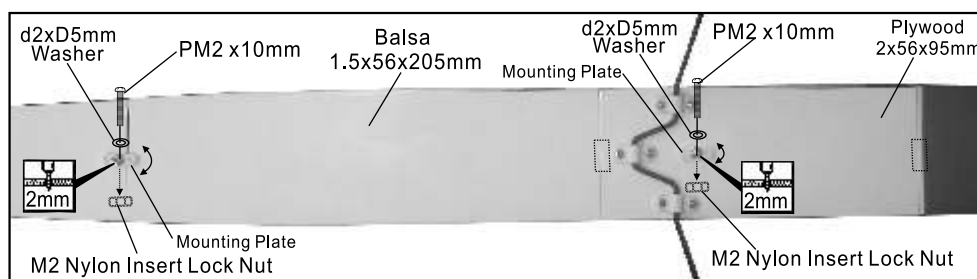
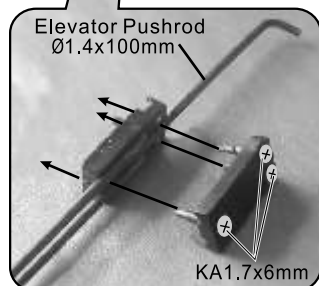
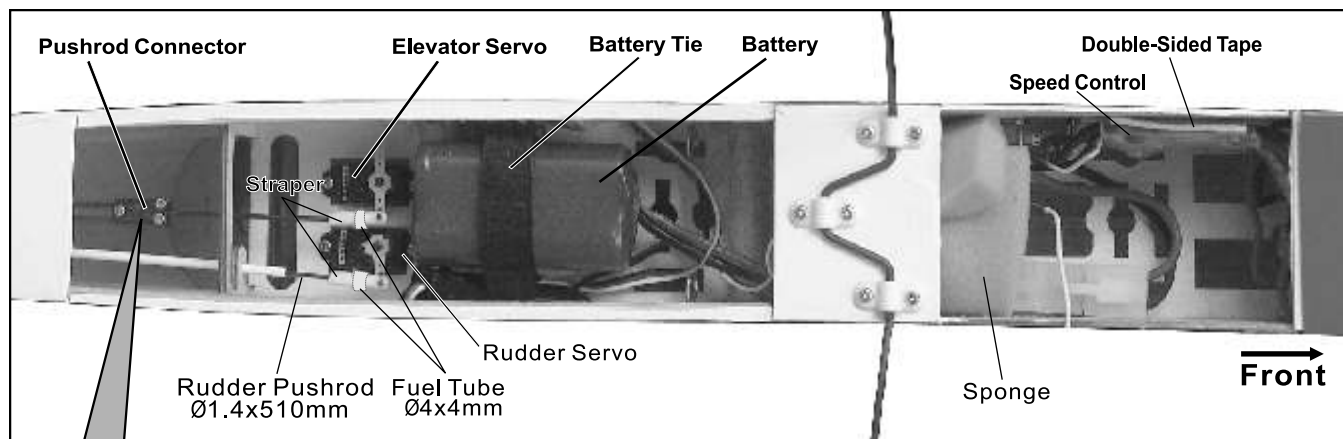
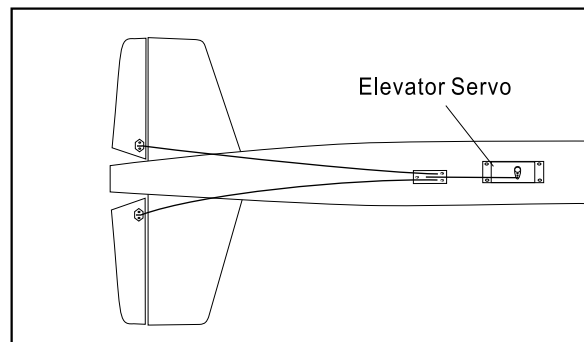

11 Canopy

PWA2x8mm **Screw**

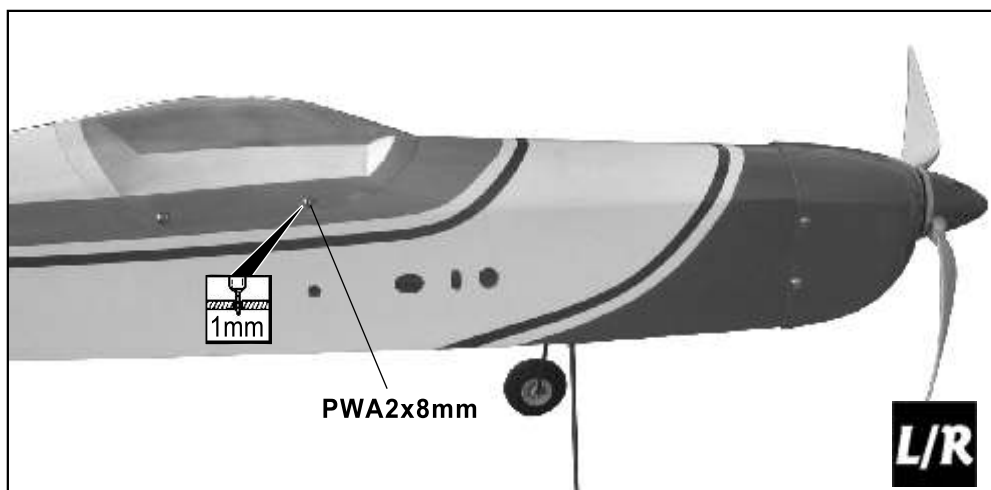
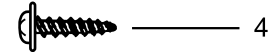

12 Main Wing

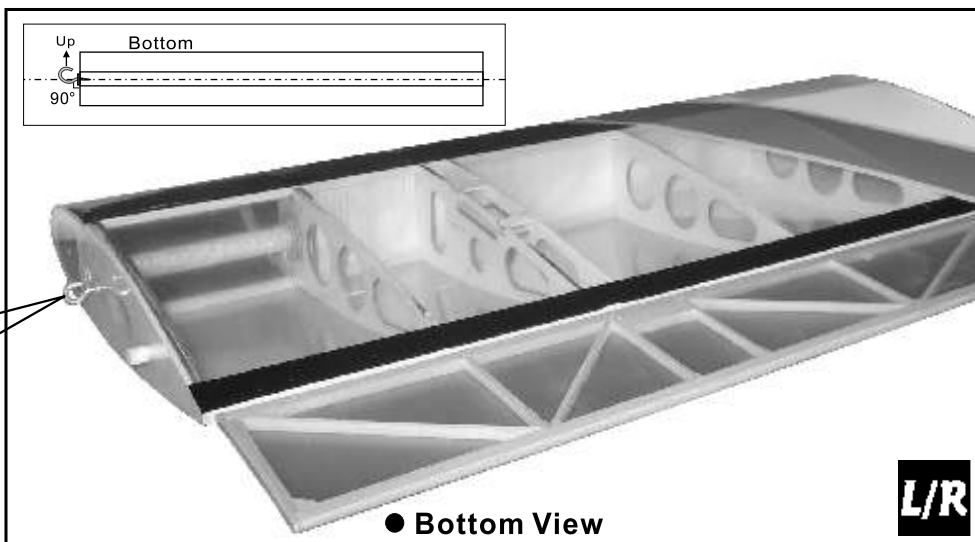
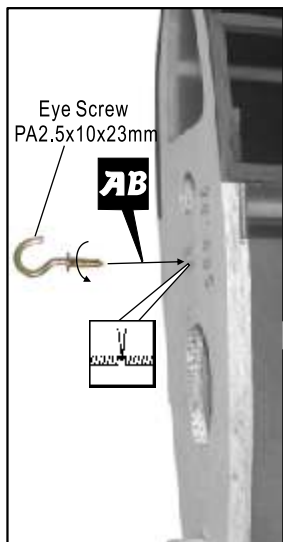

L/R

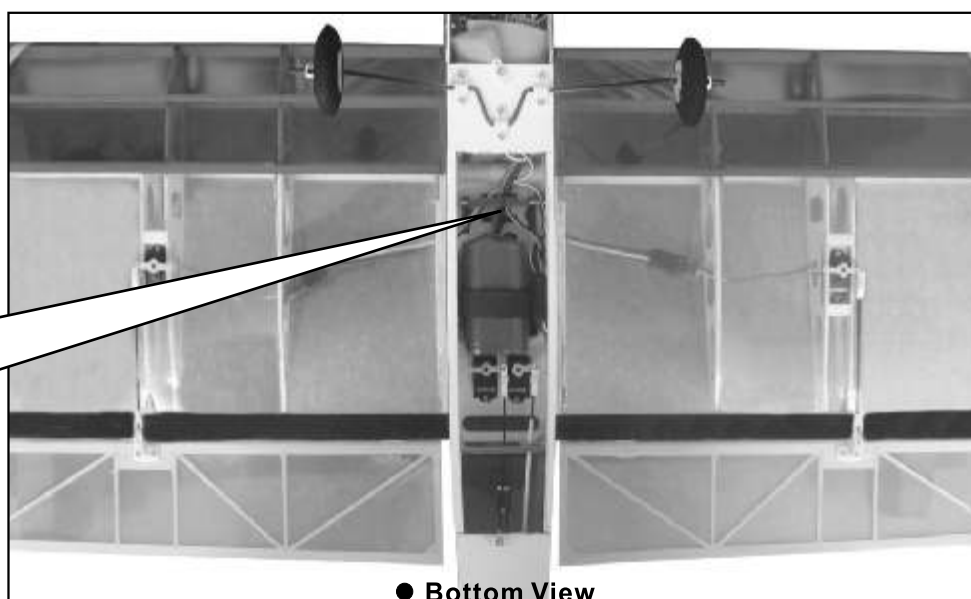
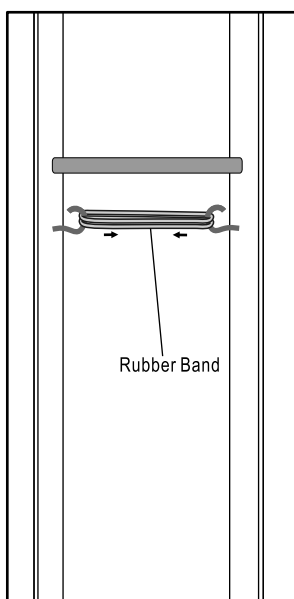
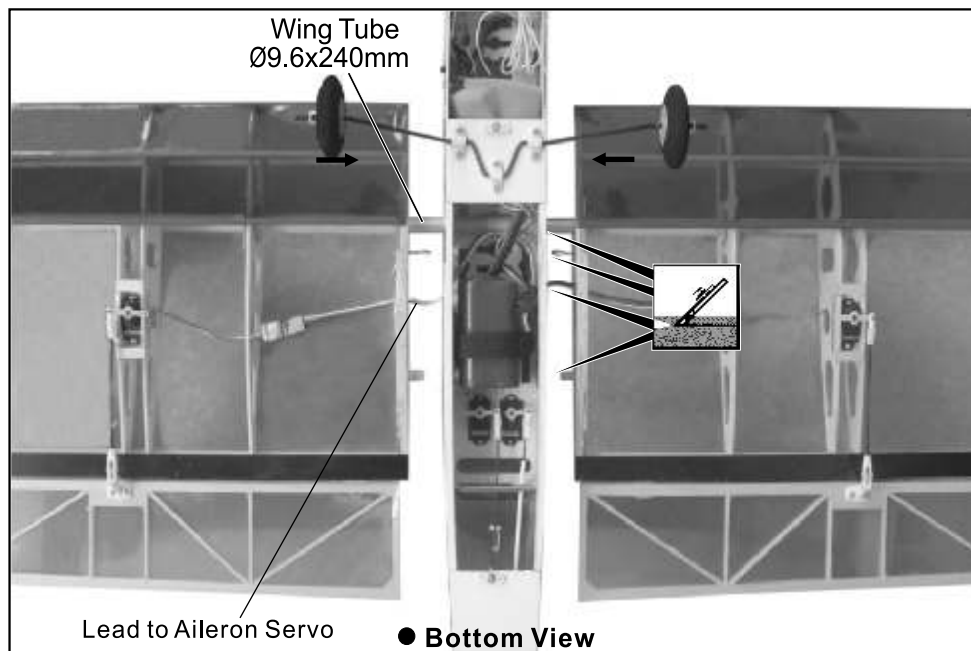

13 Wing Setting

- Adjust the wing fuselage configuration as shown in the diagrams.

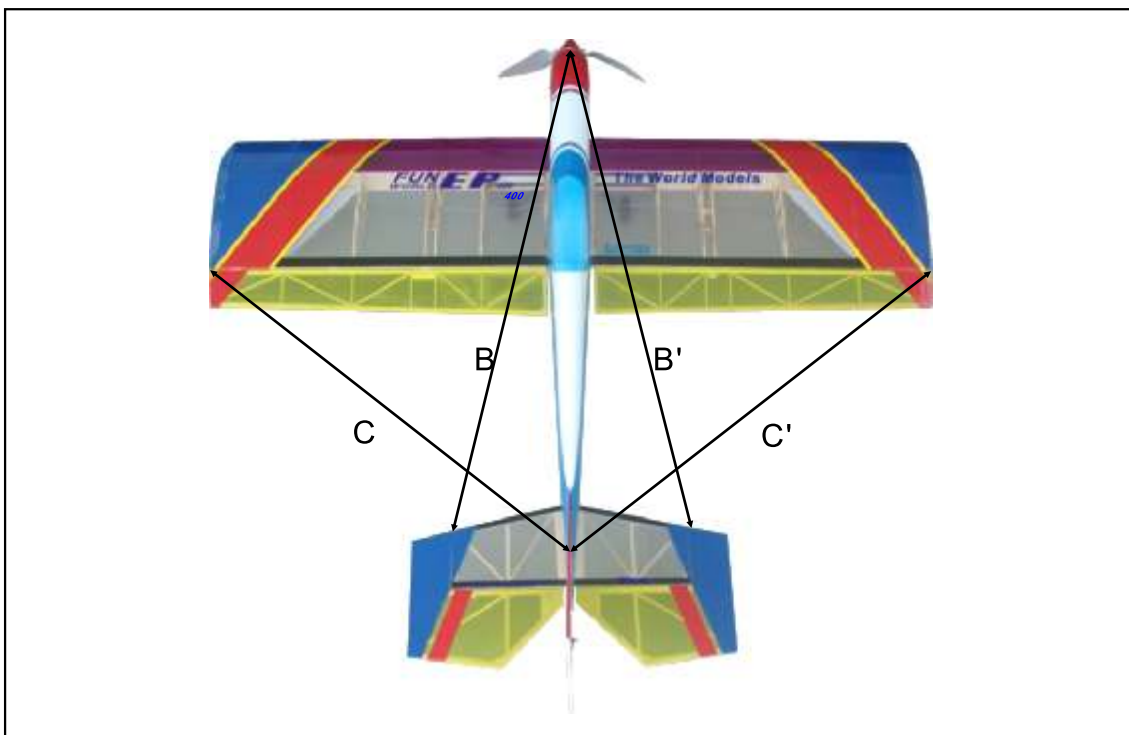
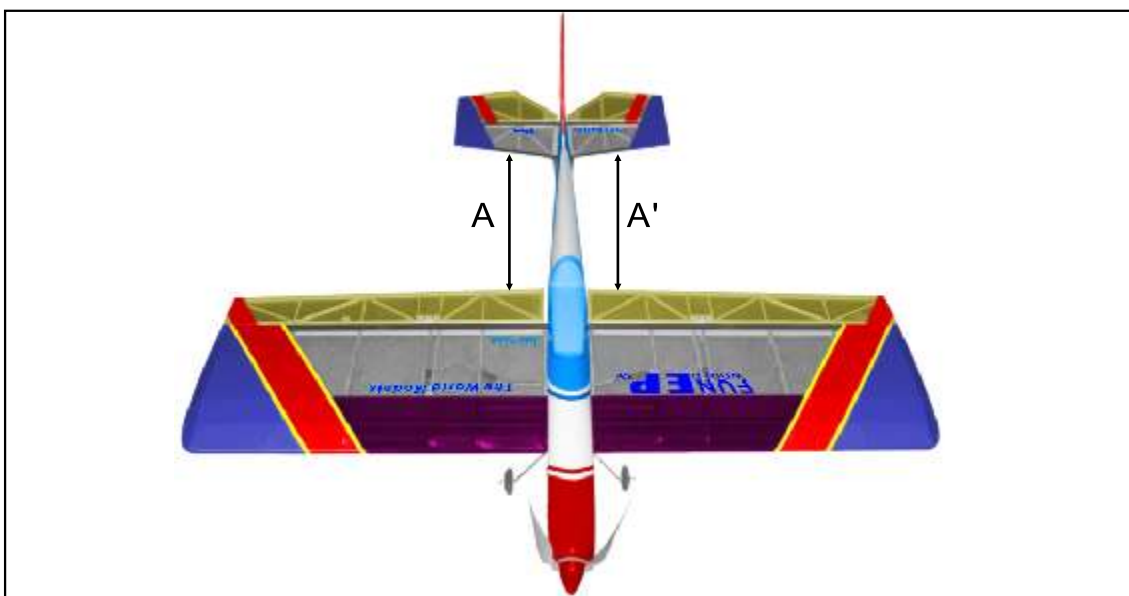

$$A=A' \quad B=B' \quad C=C'$$

13 Control Throws

Adjust the control throws as shown in the diagram. These throws are good for general flying. You can adjust according to your personal preference.

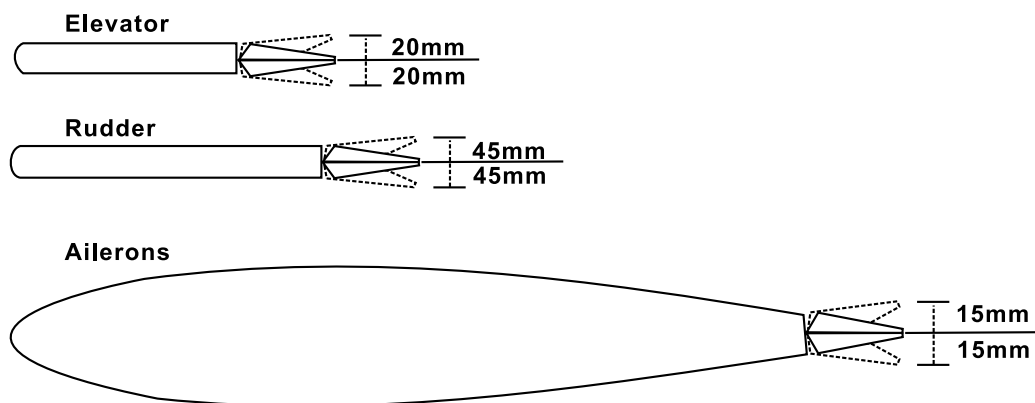

14 C.G.

The ideal C.G. position is 90mm (3.54 in.) behind the leading edge measured at where the wing meets the fuselage. In order to obtain the C.G. specified, add weight to the fuselage or move the battery position. Check the C.G. before flying.



! Warning!

Important Safety Precautions

- # First time flyer should never fly by himself/ herself. Assistance from experienced flyer is absolutely necessary.
- # Pre-flight adjustment must be done before flying, it is very dangerous to fly a badly pre-adjusted aircraft.
- # **FUN WORLD-EP₄₀₀** is specially designed to be powered by KM0203800 Outrunner Motor.
- # Make sure the air field is spacious, never fly the plane too close to people and never get too close to a running propeller.
- # If you find wrinkles on the covering as a result of weather changes, you can use hot iron to remove the wrinkles. Please begin with lower temperature setting and gradually raise the temperature until the wrinkles are gone. Too hot an iron may damage the covering.
- # Check and re-tighten up all factory assembled screws, use thread locker if applicable.



The World Models

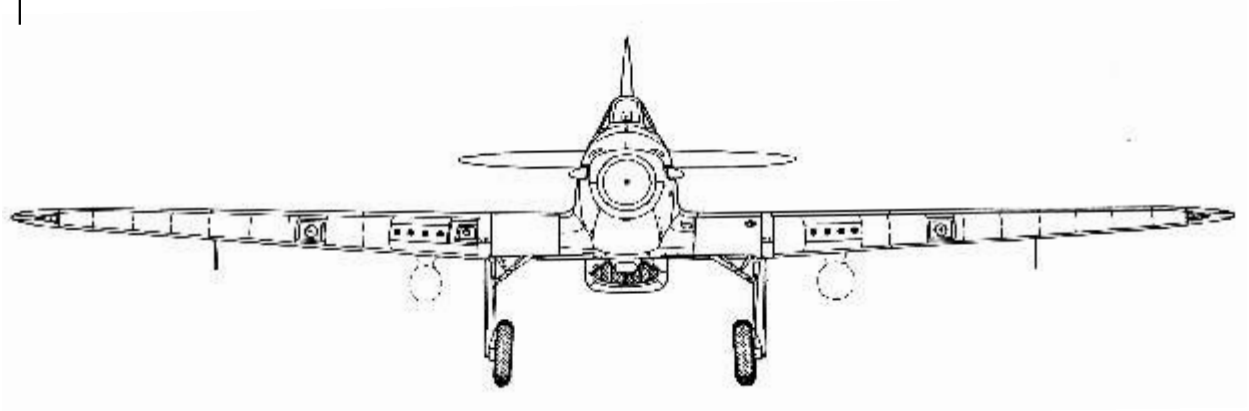

Warbirds

Pattern

Scale

Funfly

Sports

Electric

Trainer

Glider

Covering

Boat

(Lightex / Toughlon)

Accessories



<http://www.theworldmodels.com>